

BIN

Designer: SPARK

**MATERIALS**

- Zinc plated mild steel

FINISHES

- Powdercoated body & chute

SIZES

- 120 / 140 Litre
- 240 Litre

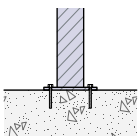
INSTALLATION

Bolt Down

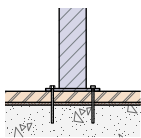

Bolt Through

FIXINGS

- 12mm fixings for 14mm diameter holes

Alternative materials and finishes available on request

FACET BIN 120L

SPECIFICATIONS

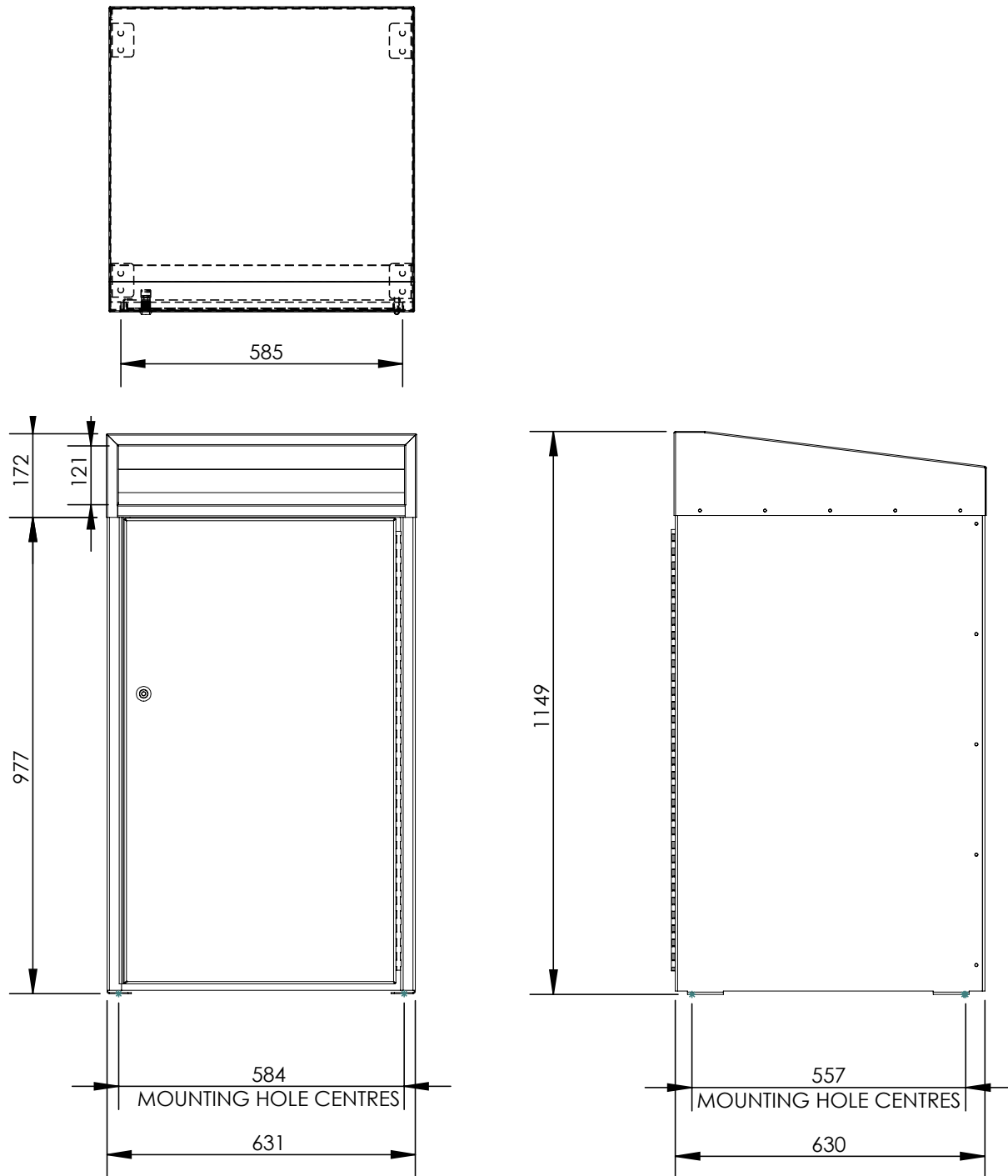

Measurements are in millimetres. Drawings are not to scale.

PRODUCT CODE

FCT001-ZIN-PC-120L-S

BODY & FINISH

Mild Steel, Powdercoated

SIZE

120L

FACET BIN 240L

SPECIFICATIONS

Dimensioned Line Drawing coming soon

Measurements are in millimetres. Drawings are not to scale.

PRODUCT CODE	BODY & FINISH	SIZE
FCT001-ZIN-PC-240L-S	Mild Steel, Powdercoated	240L